

EASY AND VERSATILE MOUNTING

Adaptor mount style enables the PRODEM compactors to be mounted to any carrier in the recommended weight class



HYDRAULIC COMPACTORS

PRODEM HYDRAULIC COMPACTORS MAXIMIZE PRODUCTIVITY AND MINIMIZE EXCAVATOR DOWNTIME WHILST IMPROVING SAFETY WHEN COMPACTING MATERIAL IN DEEP EXCAVATIONS AND EMBANKMENTS.

SINGLE HOSE BLOCKS

Valve pack as standard – flow control valve (priority flow divider) regulates hydraulic in-flow to the motor and prevents over-speeding. Thus, the compactor can be installed on carriers not equipped with a flow control valve on its auxiliary plumbing

SELF-ALIGNING BEARING

Self-aligning double row spherical roller bearing provides a long service life to rotating components

CUSHION RUBBER

Specially designed cushion rubbers protect the machine and operator from vibrations

HEAVY-DUTY GEAR MOTOR

Heavy-duty and high efficiency gear motor with splined shaft and high pressure motor seals prevent easy damage caused by pressure shock during startup and shutdown

EASY MAINTENANCE

No greasing required due to the housing acting as an oil bath

>> CROSS-CHECK VALVE AS STANDARD

Built-in cross check valve within motor protects the motor and bearing from damage caused by abrupt shutdown of hydraulic flow. It also eliminates the need for a case drain.

>> VALVE PACK AS STANDARD

Flow control valve (priority flow divider) regulates hydraulic in-flow to the motor, prevents over-speeding and means the compactor can be installed on carrier not equipped with a flow control valve on its auxiliary plumbing.

THE PRODEM COMPACTOR PLATES ARE 100% MAINTENANCE FREE, THEY OFFER A MASSIVE COMPACTION FORCE AND GREAT RELIABILITY.



TECHNICAL SPECIFICATION

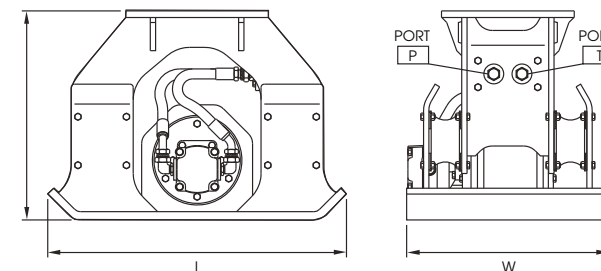

ADAPTOR MOUNT STYLE (FLAT TOP) - PA SERIES

Model	Excavator Weight Class (t)	Working - Adaptor Mount Type (kg)	Baseplate Size - W x L (mm)	Impulse Force (t)	Vibrations (per min)	Required Oil Flow (l/min)	Operating Pressure (bar)
PHC030	1.5-5	190	290 x 710	1.5	2100	30	160
PHC050N	4-6	261	320 x 745	2.1	2100	45-65	100-220
PHC050G	4-6	341	500 x 800	2.1	2100	45-65	100-220
PHC100	6-13	430	610 x 900	4	2000	50-120	100-138
PHC150	11-20	689	740 x 1050	6.4	2000	80-170	100-138
PHC200	17-27	1094	860 x 1200	11.2	2000	110-200	100-138
PHC300	26-40	1502	1000 x 1300	17.3	2000	160-250	100-138